

J2012 Double Balanced Mixer

2.0 to 12.0 GHz

Technical Characteristics



Product Features
Multi-octave bandwidth
Broad frequency - input and output
Wide DC to IF frequency response
Low conversion loss
High port-to-port isolation

Maximum Ratings	
Storage Temperature	-65 to +100°C
Operating Temperature Peak	-54 to +100°C
Peak Input Power For Any Single Port	+23dBm Peak
Peak Input Power For Any Port	+26dBm peak
Peak Input Current @ +25° C	100mA

Parameters	Freq. (GHz)	Minimum	Typical	Maximum	Units	Conditions
Conversion Loss						
RF Input	2.0 to 12.0		5.5	7.5	dB	IF = 100 MHz
LO Input	2.0 to 12.0		7.0	8.5	dB	IF = 2000 MHz
IF Output	DC to 2.0					
Conversion Flatness						
Isolation						
LO-RF	2.0 to 8.0	28.0	35.0		dB	
LO-IF	2.0 to 12.0	18.0	25.0		dB	
RF-IF	2.0 to 12.0		30.0		dB	
VSWR						
1dB Comp.Point						
J2012L			1.0		dBm	
LO Drive						
J2012L		7.0	9.0		dBm	
J2012N			13.0		dBm	
Input TOIP						
J2012L			11.0		dBm	
J2012M			11.0		dBm	
J2012H			16.0		dBm	
J2012N			11.0		dBm	

NOTES:

1. Measured in a 50 ohm system with nominal LO drive and downconverter application only, unless otherwise specified. The I-port frequency range extends to DC for phase detection, pulse modulation, or attenuator applications. I-port VSWR degrades from a 50 Ω system at LO-IF frequencies.

2. Typical values are measured at +25°C and are not guaranteed.

Package outline Z

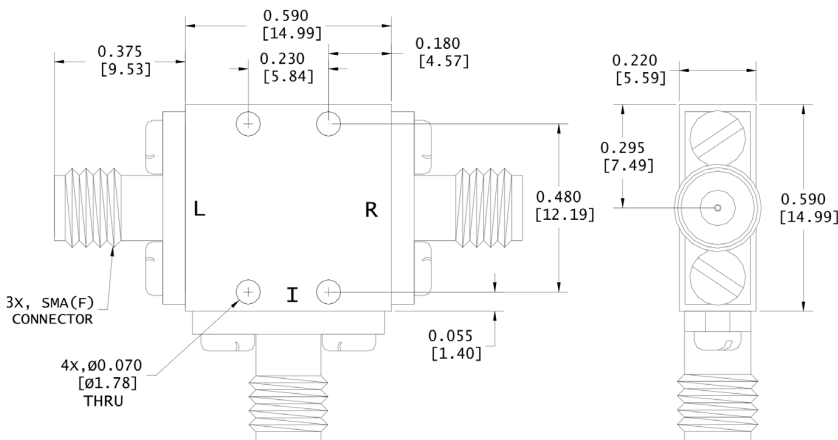

Product Export Classification
ECCN: EAR 99 (unless otherwise specified)
HTS: 8541.10.0060



1

DISCLAIMER: Subject to change without notice.

Quality products that serve the industry. Today and tomorrow.

Copyright © EclipseMDI



www.eclipseMDI.com



1.408.526.1100

EclipseMDI

sales@eclipsemdi.com

J2012 Double Balanced Mixer

2.0 to 12.0

Outline Drawings 1 of 2

Coaxial Package outline 'B'

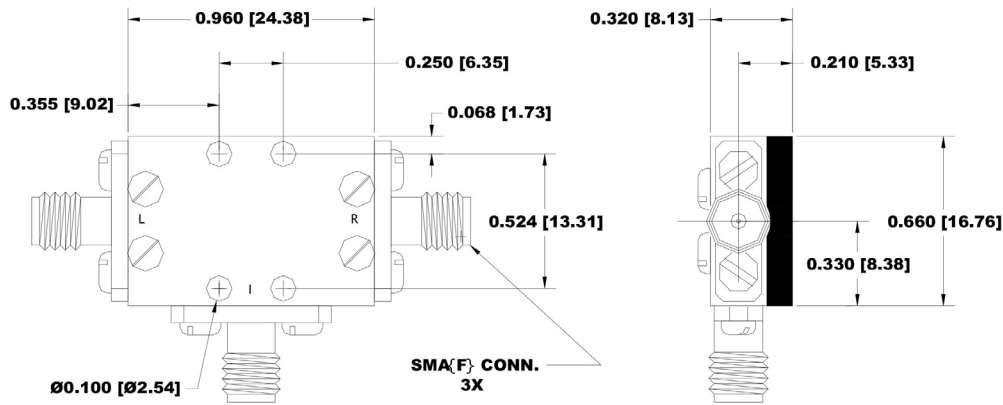

Coaxial Package outline 'L'

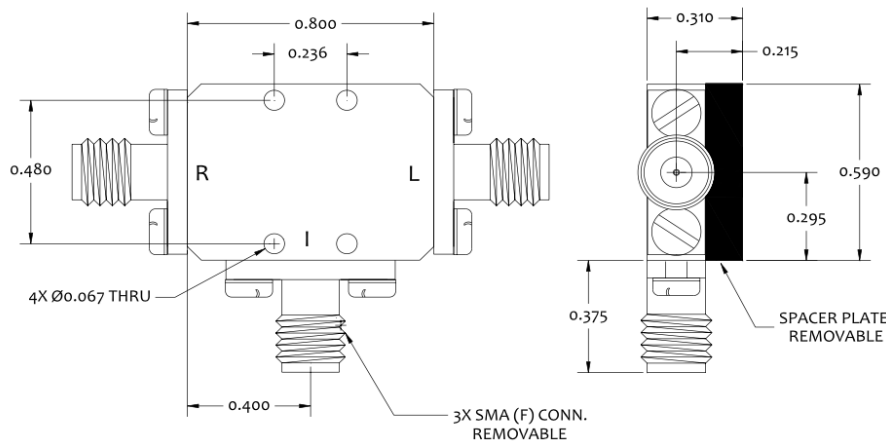

Coaxial Package outline 'C'

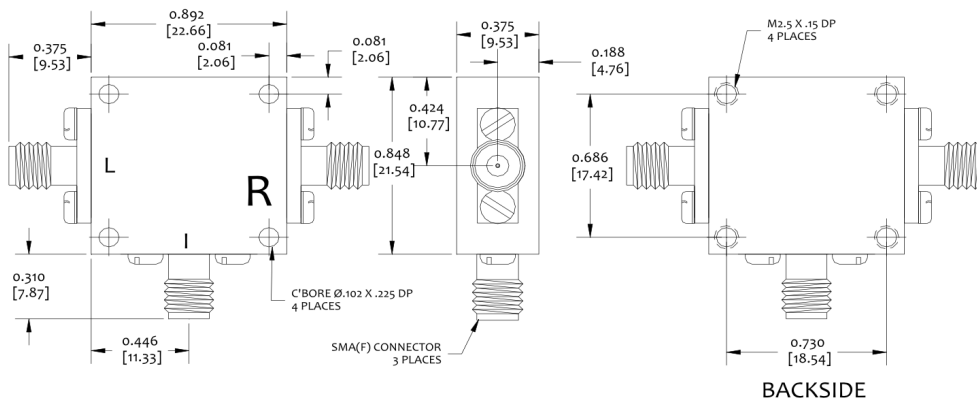

J2012 Double Balanced Mixer

2.0 to 12.0

Outline Drawings 2 of 2

Drop in Package outline 'E1'

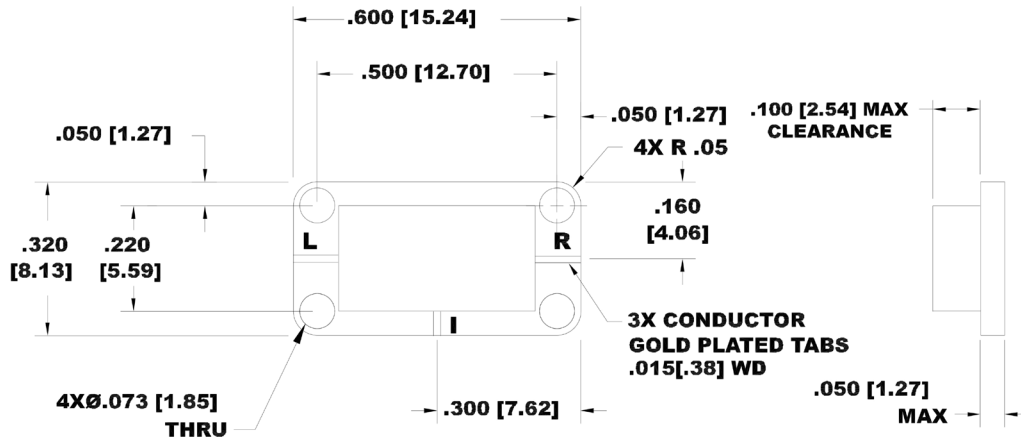

Drop in Package outline 'F1'

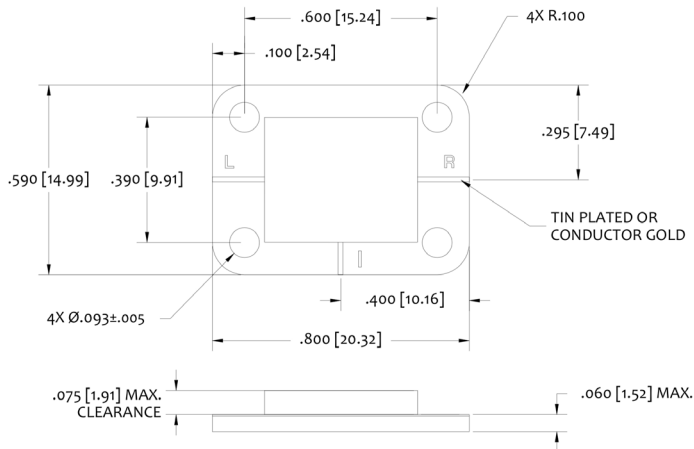

Drop in Package outline 'ZX'

